



# FAN DECKS

DXC SERIES - STEEL WHEEL

DXG SERIES - PLASTIC WHEEL

**REGAL**®

# FAN DECKS

## CONTENTS

DESCRIPTION	3
PART NUMBER IDENTIFICATION	3
DXG203-203-401, Plastic Wheel, Standard Housing	4
DXG203T203-401, Plastic Wheel, Tight Housing	5
DXG203-203-404, Plastic Wheel, Standard Housing	6
DXG203T203-404, Plastic Wheel, Tight Housing	7
DXG203-203-441, Plastic Wheel, Standard Housing	8
DXC241-181-441, Steel Wheel, Standard Housing	9
DXC241T181-441, Steel Wheel, Tight Housing	10
DXG241-181-441, Plastic Wheel, Standard Housing	11
DXG241T181-441, Plastic Wheel, Tight Housing	12
DXC241-181-521, Steel Wheel, Standard Housing	13
DXC241T181-521, Steel Wheel, Tight Housing	14
DXG241-181-521, Plastic Wheel, Standard Housing	15
DXG241T181-521, Plastic Wheel, Tight Housing	16
DXG241T241-441, Plastic Wheel, Tight Housing	17
DXC241-241-521, Steel Wheel, Standard Housing	18
DXG241-241-521, Plastic Wheel, Standard Housing	19
DXC241-241-523, Steel Wheel, Standard Housing	20
DXC241-241-541, Steel Wheel, Standard Housing	21
DXG241-241-541, Plastic Wheel, Standard Housing	22

# INTRODUCTION

## DESCRIPTION

This type of fan is a direct drive fan deck, referring to the use of twin forward curved fan blowers mounted onto a base tray. The fan features a centrally mounted double shaft motor, directly coupled to the forward curved wheels inside the blower housings.

The direct drive fan decks wheels can be made from 2 different materials, high temp plastic or metal.

A range of motors are available ranging from 180W through to 1500W, achieving airflow performance of up to 2200 l/s.

All motors are fitted with thermal overload protection and insulation that conforms to Class B. F Class motors can be fitted upon request.

All performance data featured in this catalogue have been carried out on an air flow chamber conforming to design requirements stated in BS848.

All tests are carried out in non-ducted or type A insulation.

## PART NUMBER IDENTIFICATION

When placing an order the blower product code should be specified. The product code of the blower is composed in accordance with the following example:

<b>D</b>	<b>X</b>	<b>G</b>	<b>2 0 3</b>	<b>T</b>	<b>2 0 3</b>	<b>-</b>	<b>4 0 1</b>
1	2	3	4 - 6	7	8 - 10		11-13

### POSITION 1

Type of drive

**D** = Direct

### POSITION 2

Configuration

**X** = Twin housings double inlet

### POSITION 3

Wheel type

**A** = Louvre strip (R)

**C** = Steel

**G** = Plastic

### POSITIONS 4 TO 6

Wheel diameter

In millimeters

### POSITION 7

Housing

**DASH** = Standard housing

**T** = Tight housing

### POSITIONS 8 TO 10

Wheel width

In millimeters

### POSITIONS 11 TO 13

Final code

**ODD NUMBERS** = Mechanical build variance

Code examples:

DXC241-241-541

DXG203T203-404

# FAN DECKS

## 203MM DIAMETER • 203MM WIDTH

### HOUSING

G2 Galvabond®\* Steel Z275

### MOTOR

240 volts, 50 Hz  
 4 Pole  
 3 Speed  
 Ball Bearings  
 Class B Insulation  
 Automatic Thermal Overload Protection

### WHEEL

Polypropylene

Unit Weight (kg)	16.0
Motor Part #	8061S109-04
Phase / Type	1ph CSR
Watts Output	425
Venting	Fully
Main Lead	1300
Connectors	B and E on earth
Capacitor Size	10 MFD
Capacitor Lead	1300
Connectors	F

B: Bootlace  
 E: Eyelet  
 F: Flag Terminals + Insulator on capacitor lead

### DIMENSIONS

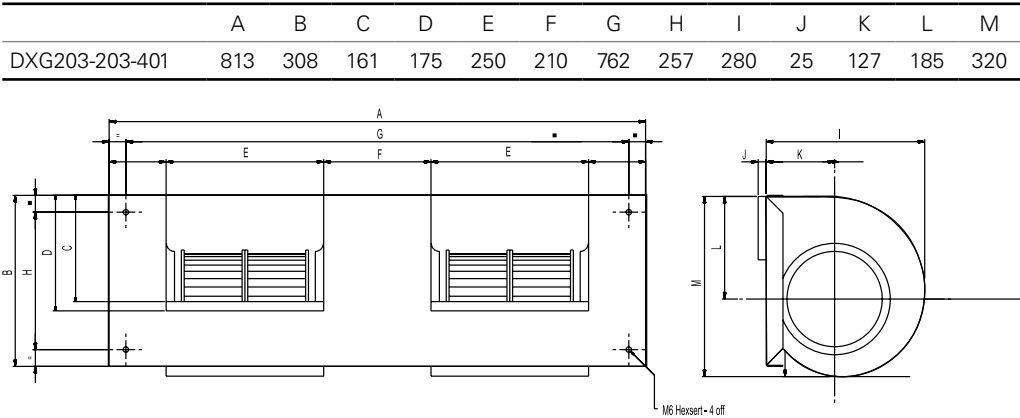

### PERFORMANCE GRAPH

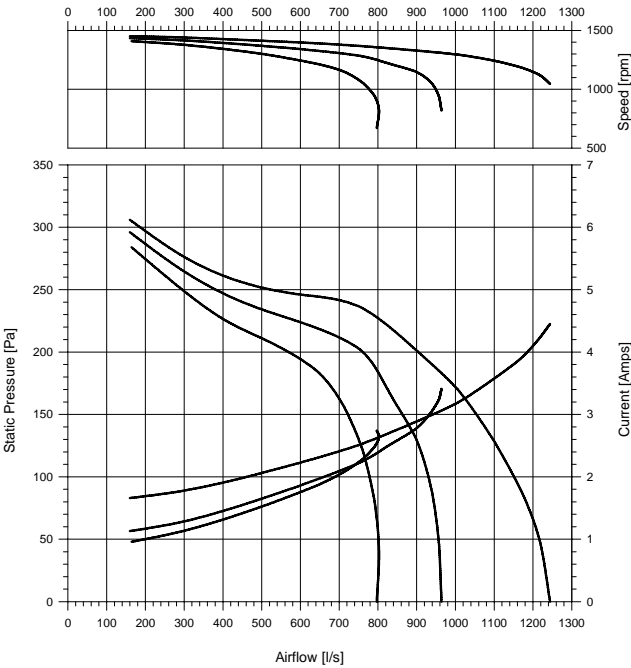

### WIRING DIAGRAM

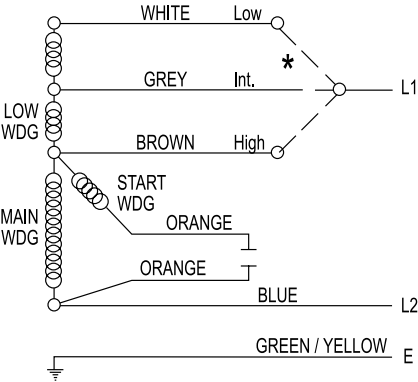

# FAN DECKS

## 203MM DIAMETER • 203MM WIDTH

### HOUSING

G2 Galvabond®\* Steel Z275

### MOTOR

240 volts, 50 Hz  
4 Pole  
3 Speed  
Ball Bearings  
Class B Insulation  
Automatic Thermal Overload Protection

### WHEEL

Polypropylene

Unit Weight (kg)	15.5
Motor Part #	8061S109-04
Phase / Type	1ph CSR
Watts Output	425
Venting	Fully
Main Lead	1300
Connectors	B and E on earth
Capacitor Size	10 MFD
Capacitor Lead	1300
Connectors	F

B: Bootlace  
E: Eyelet  
F: Flag Terminals with Insulators

### DIMENSIONS

	A	B	C	D	E	F	G	H	I	J	K	L	M
DXG203T203-401	813	308	161	175	250	210	762	257	267	25	127	178	303

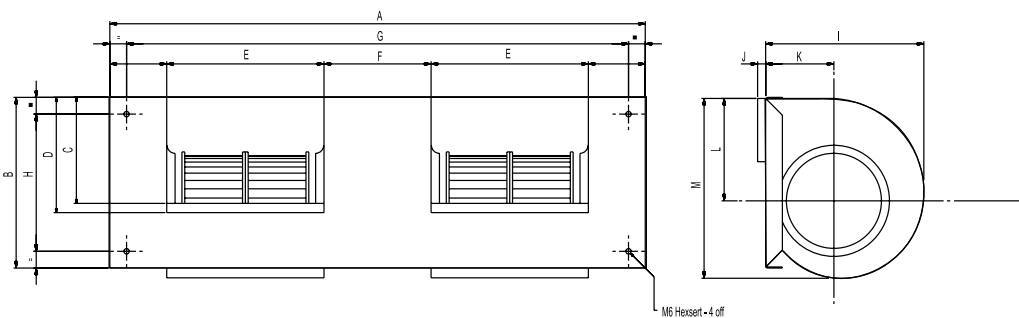

### PERFORMANCE GRAPH

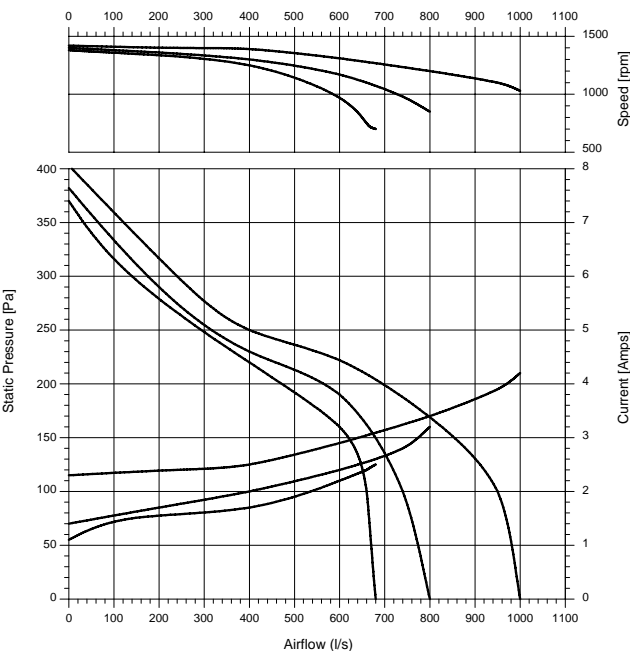

### WIRING DIAGRAM

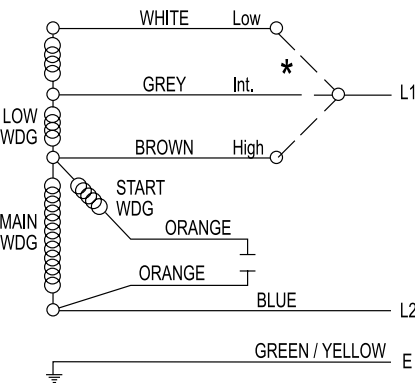

# FAN DECKS

## 203MM DIAMETER • 203MM WIDTH

### HOUSING

G2 Galvabond®\* Steel Z275

### MOTOR

240 volts, 50 Hz  
 4 Pole  
 3 Speed  
 Ball Bearings  
 Class B Insulation  
 Automatic Thermal Overload Protection

### WHEEL

Polypropylene

Unit Weight (kg)	16.0
Motor Part #	8061S109-04
Phase / Type	1ph CSR
Watts Output	315
Venting	Fully
Main Lead	1300
Connectors	B and E on earth
Capacitor Size	4 MFD
Capacitor Lead	1300
Connectors	F

B: Bootlace  
 E: Eyelet  
 F: Flag Terminals + Insulator on capacitor lead

### DIMENSIONS

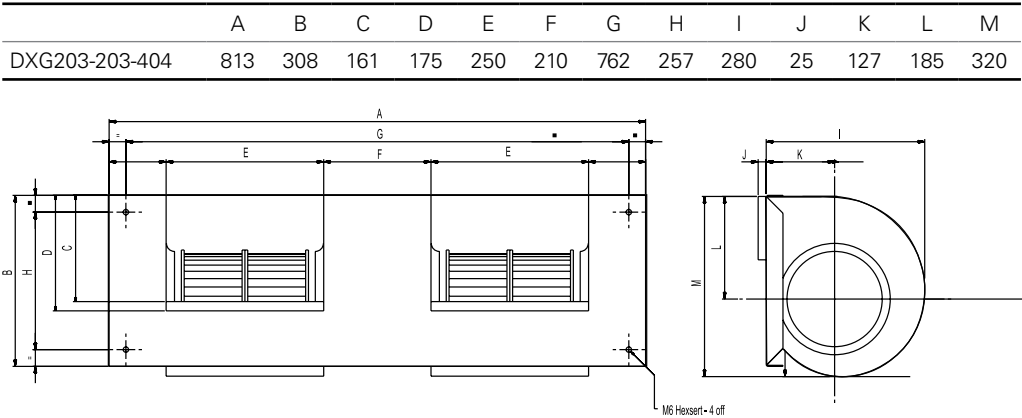

### PERFORMANCE GRAPH

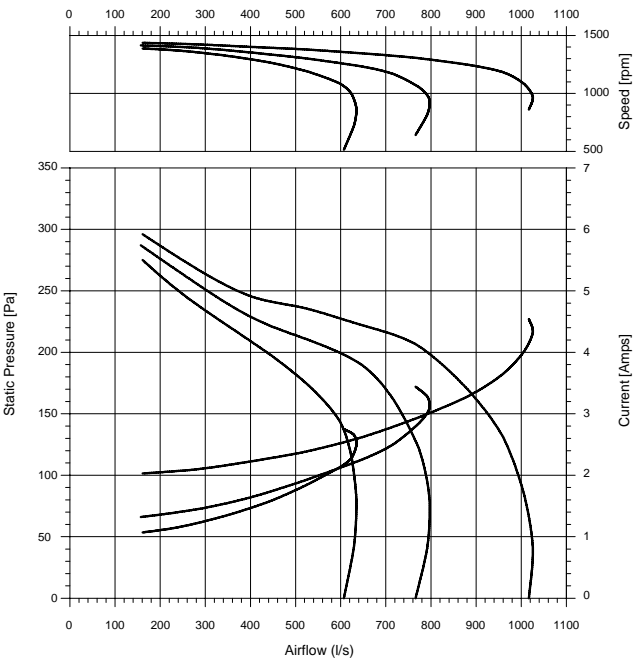

### WIRING DIAGRAM

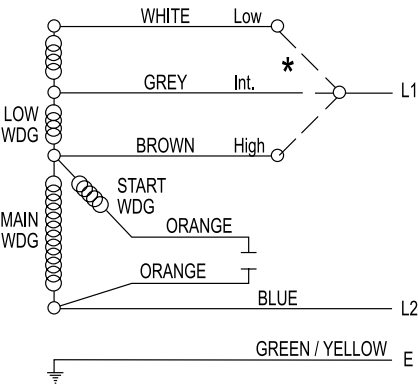

# FAN DECKS

## 203MM DIAMETER • 203MM WIDTH

### HOUSING

G2 Galvabond®\* Steel Z275

### MOTOR

240 volts, 50 Hz  
4 Pole  
3 Speed  
Ball Bearings  
Class B Insulation  
Automatic Thermal Overload Protection

### WHEEL

Polypropylene

Unit Weight (kg)	15.5
Motor Part #	8061S109-04
Phase / Type	1ph CSR
Watts Output	315
Venting	Fully
Main Lead	1300
Connectors	B and E on earth
Capacitor Size	4 MFD
Capacitor Lead	1300
Connectors	F

B: Bootlace  
E: Eyelet  
F: Flag Terminals with Insulators

### DIMENSIONS

	A	B	C	D	E	F	G	H	I	J	K	L	M
DXG203T203-404	813	308	161	175	250	210	762	257	267	25	127	178	303

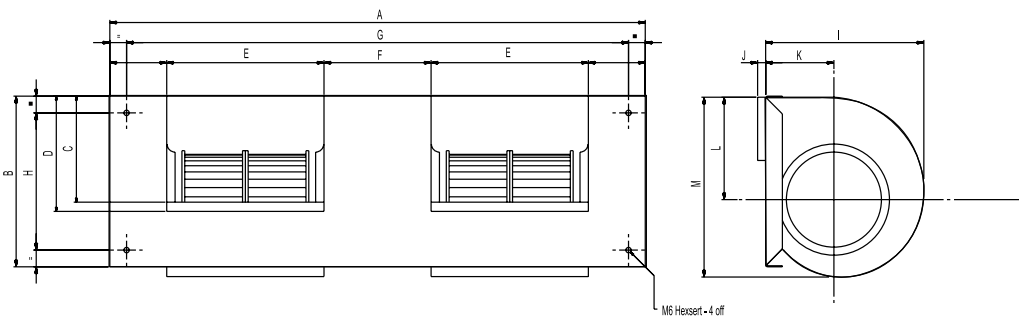

### PERFORMANCE GRAPH

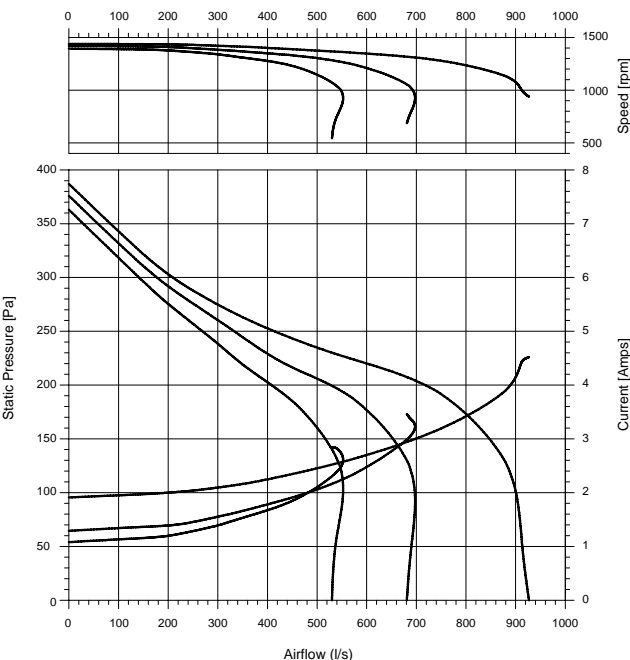

### WIRING DIAGRAM

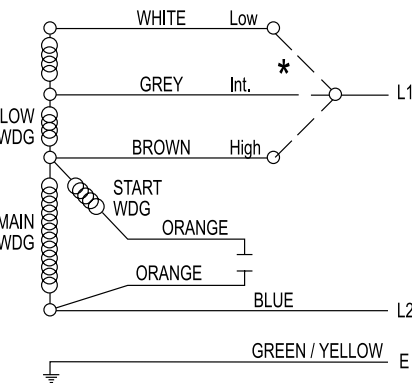

# FAN DECKS

## 203MM DIAMETER • 203MM WIDTH

### HOUSING

G2 Galvabond®\* Steel Z275

### MOTOR

240 volts, 50 Hz  
 4 Pole  
 3 Speed  
 Ball Bearings  
 Class B Insulation  
 Automatic Thermal Overload Protection

### WHEEL

Polypropylene

Unit Weight (kg)	18.0
Motor Part #	808555PVA-A11
Phase / Type	1ph CSR
Watts Output	600
Venting	Fully
Main Lead	1000
Connectors	B and E on earth
Capacitor Size	15 MFD
Capacitor Lead	1000
Connectors	F

B: Bootlace  
 E: Eyelet  
 F: Flag Terminals + Insulator on capacitor lead

### DIMENSIONS

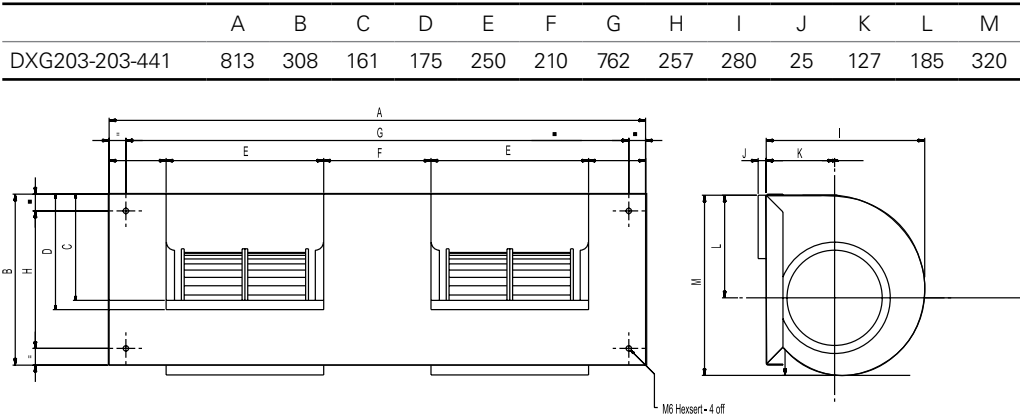

### PERFORMANCE GRAPH

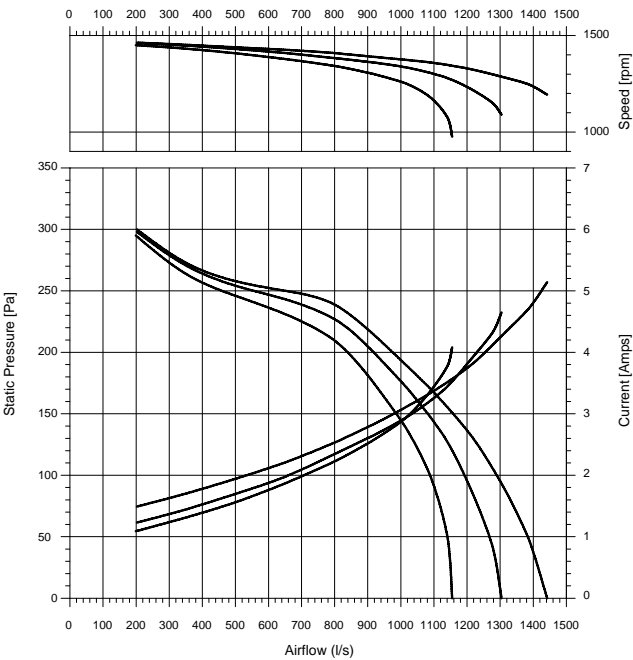

### WIRING DIAGRAM

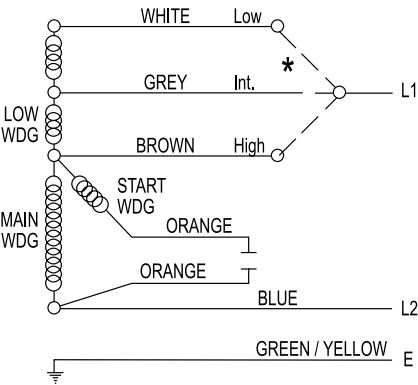



# FAN DECKS

## 241MM DIAMETER • 181MM WIDTH

### HOUSING

G2 Galvabond®\* Steel Z275

### MOTOR

240 volts, 50 Hz  
4 Pole  
3 Speed  
Ball Bearings  
Class B Insulation  
Automatic Thermal Overload Protection

### WHEEL

Steel

Unit Weight (kg)	22.0
Motor Part #	808555PVA-A11
Phase / Type	1ph CSR
Watts Output	600
Venting	Fully
Main Lead	1000
Connectors	B and E on earth
Capacitor Size	15 MFD
Capacitor Lead	1000
Connectors	F

B: Bootlace  
E: Eyelet  
F: Flag Terminals + Insulator on capacitor lead

### DIMENSIONS

	A	B	C	D	E	F	G	H	I	J	K	L	M
DXC241-181-441	810	300	185	195	234	228	762	258	380	-	185	220	392

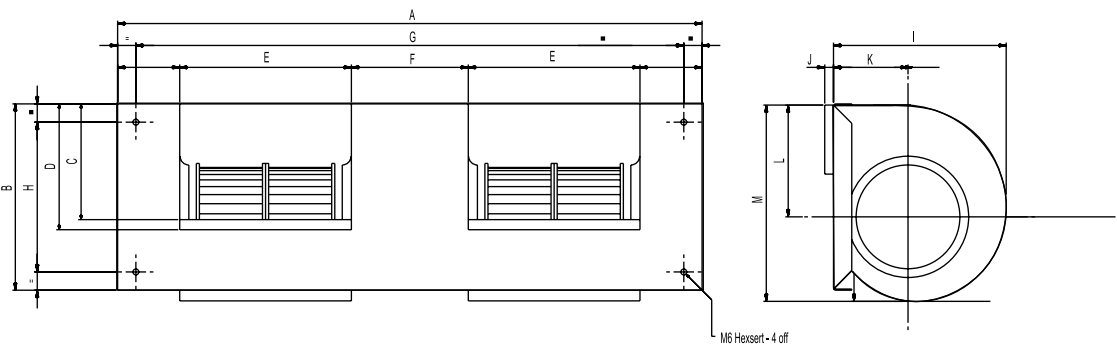

### PERFORMANCE GRAPH

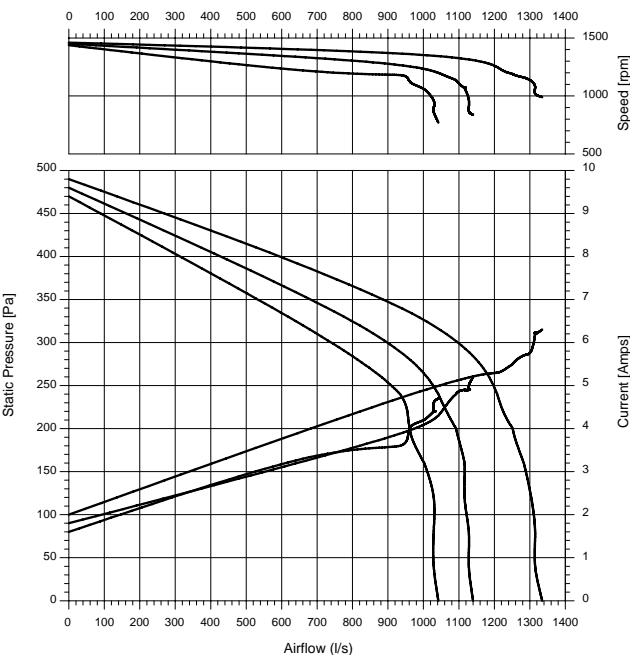

### WIRING DIAGRAM

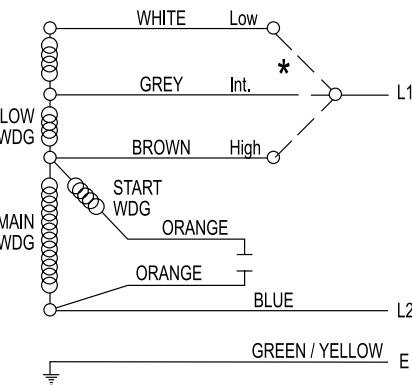

# FAN DECKS

## 241MM DIAMETER • 181MM WIDTH

### HOUSING

G2 Galvabond®\* Steel Z275

### MOTOR

240 volts, 50 Hz  
 4 Pole  
 3 Speed  
 Ball Bearings  
 Class B Insulation  
 Automatic Thermal Overload Protection

### WHEEL

Steel

Unit Weight (kg)	22.0
Motor Part #	808555PVA-a11
Phase / Type	1ph CSR
Watts Output	600
Venting	Fully
Main Lead	1000
Connectors	B and E on earth
Capacitor Size	15 MFD
Capacitor Lead	1000
Connectors	F

B: Bootlace  
 E: Eyelet  
 F: Flag Terminals + Insulator on capacitor lead

### DIMENSIONS

	A	B	C	D	E	F	G	H	I	J	K	L	M
DXC241T181-441	813	308	165	175	234	239	762	257	325	-	160	185	327

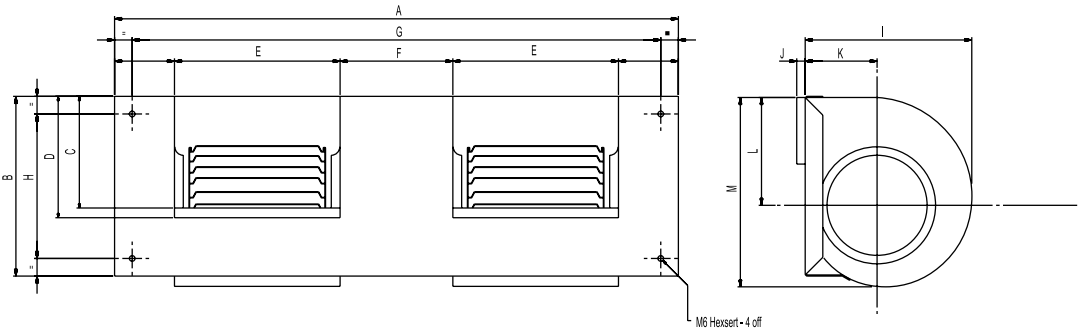

### PERFORMANCE GRAPH

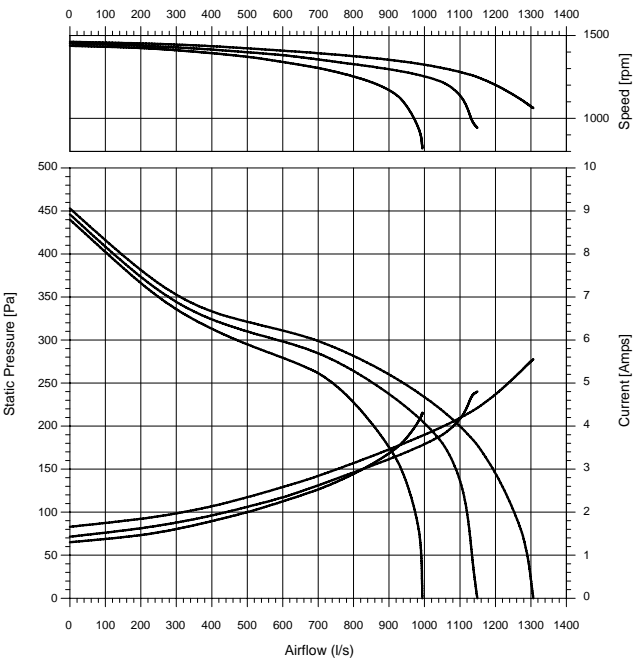

### WIRING DIAGRAM

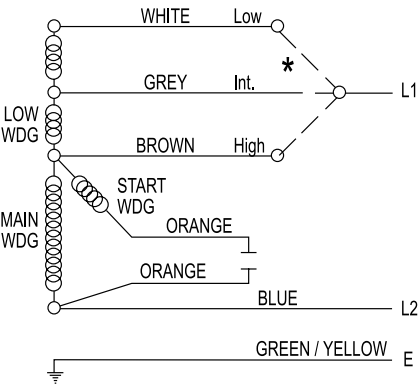

# FAN DECKS

## 241MM DIAMETER • 181MM WIDTH

### HOUSING

G2 Galvabond®\* Steel Z275

### MOTOR

240 volts, 50 Hz  
4 Pole  
3 Speed  
Ball Bearings  
Class B Insulation  
Automatic Thermal Overload Protection

### WHEEL

Polypropylene

Unit Weight (kg)	23.0
Motor Part #	808555PVA-A11
Phase / Type	1ph CSR
Watts Output	600
Venting	Fully
Main Lead	1000
Connectors	B and E on earth
Capacitor Size	15 MFD
Capacitor Lead	1000
Connectors	F

B: Bootlace  
E: Eyelet  
F: Flag Terminals + Insulator on capacitor lead

### DIMENSIONS

	A	B	C	D	E	F	G	H	I	J	K	L	M
DXG241-181-441	810	300	185	195	234	228	762	257	380	-	185	220	392

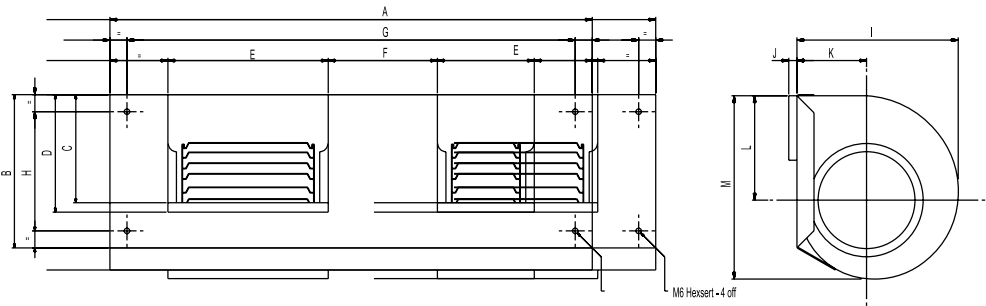

### PERFORMANCE GRAPH

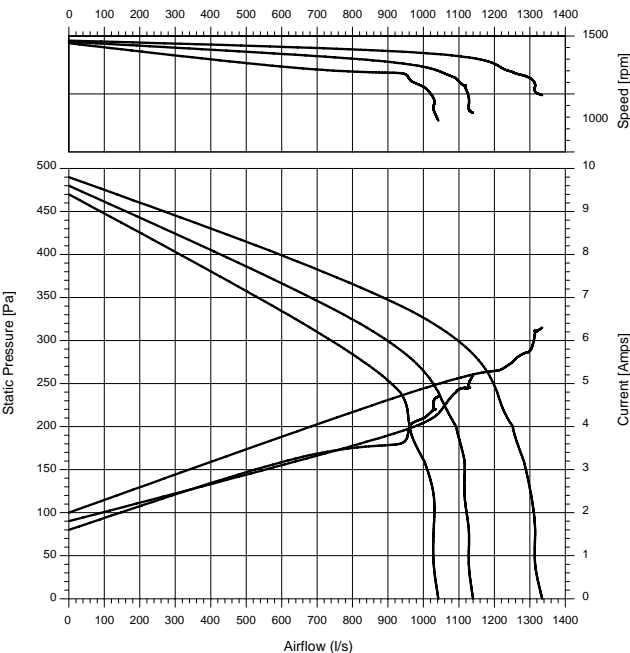

### WIRING DIAGRAM

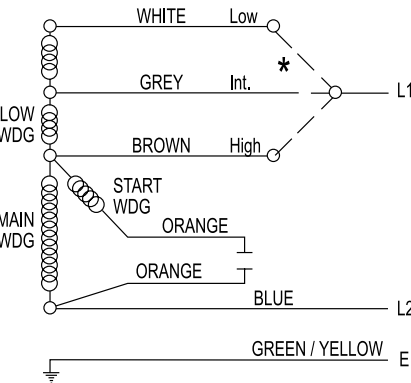

# FAN DECKS

## 241MM DIAMETER • 181MM WIDTH

### HOUSING

G2 Galvabond®\* Steel Z275

### MOTOR

240 volts, 50 Hz  
 4 Pole  
 3 Speed  
 Ball Bearings  
 Class B Insulation  
 Automatic Thermal Overload Protection

### WHEEL

Polypropylene

Unit Weight (kg)	22.0
Motor Part #	808555PVA-a11
Phase / Type	1ph CSR
Watts Output	600
Venting	Fully
Main Lead	1000
Connectors	B and E on earth
Capacitor Size	15 MFD
Capacitor Lead	1000
Connectors	F

B: Bootlace  
 E: Eyelet  
 F: Flag Terminals + Insulator on capacitor lead

### DIMENSIONS

	A	B	C	D	E	F	G	H	I	J	K	L	M
DXG241T181-441	813	308	165	175	234	239	762	257	325	-	160	185	327

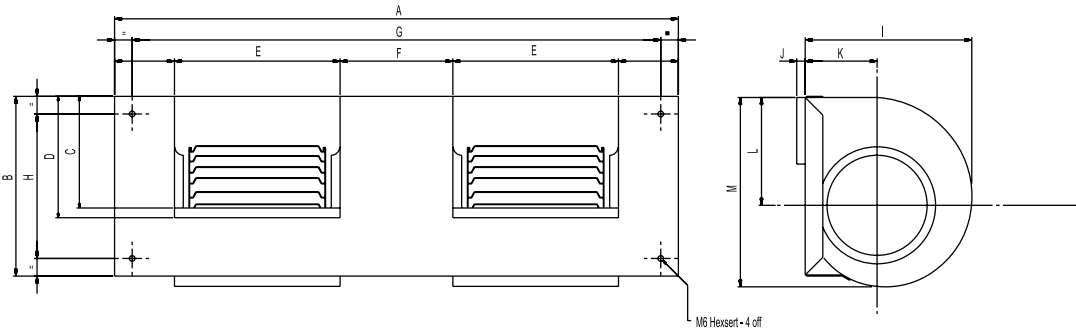

### PERFORMANCE GRAPH

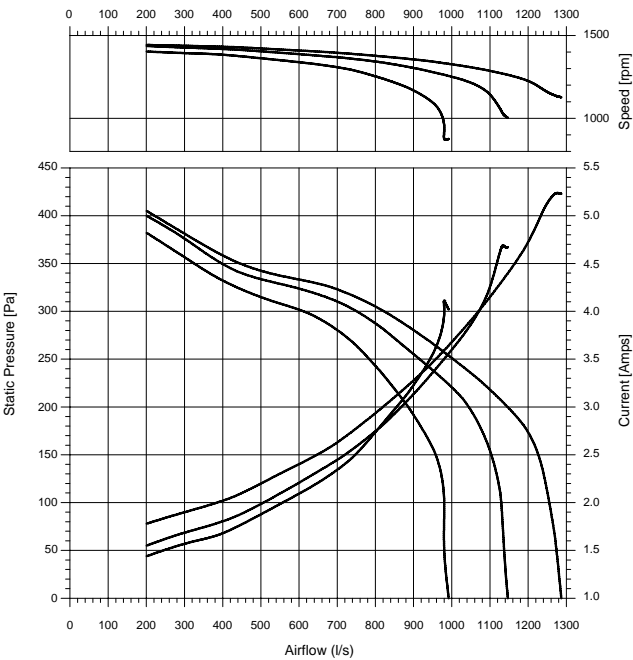

### WIRING DIAGRAM

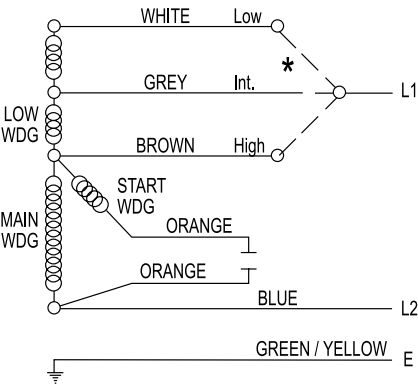

# FAN DECKS

## 241MM DIAMETER • 181MM WIDTH

### HOUSING

G2 Galvabond®\* Steel Z275

### MOTOR

240 volts, 50 Hz  
4 Pole  
3 Speed  
Ball Bearings  
Class B Insulation  
Automatic Thermal Overload Protection

### WHEEL

Steel

Unit Weight (kg)	23.0
Motor Part #	808555QVA-A11
Phase / Type	1ph CSR
Watts Output	750
Venting	Fully
Main Lead	1300
Connectors	B and E on earth
Capacitor Size	15 MFD
Capacitor Lead	1300
Connectors	F

B: Bootlace  
E: Eyelet  
F: Flag Terminals + Insulator on capacitor lead

### DIMENSIONS

	A	B	C	D	E	F	G	H	I	J	K	L	M
DXC241-181-521	810	300	185	195	234	228	762	257	380	-	185	220	392

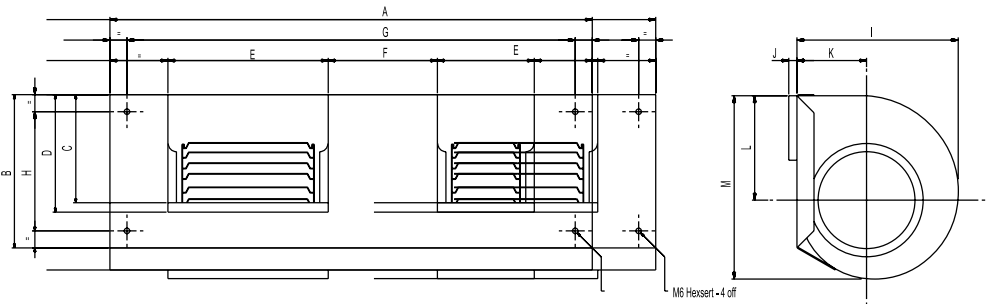

### PERFORMANCE GRAPH

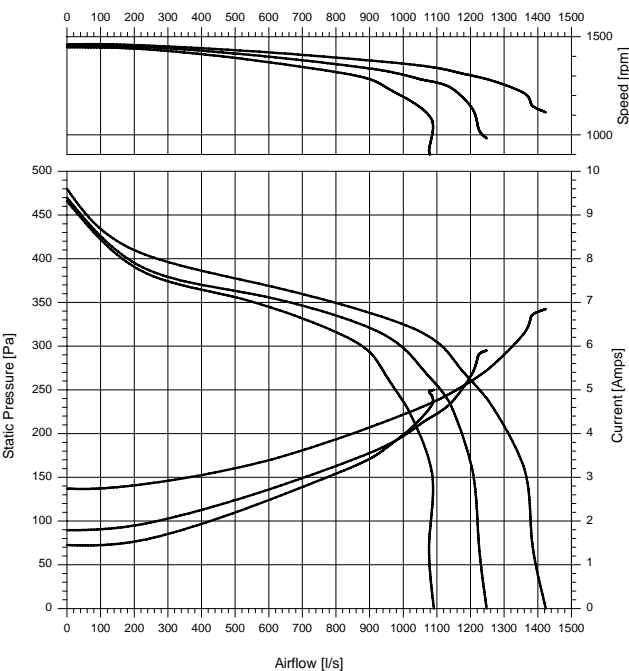

### WIRING DIAGRAM

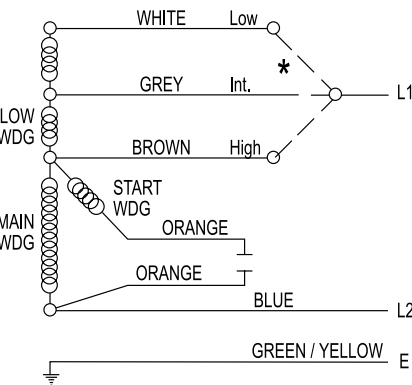

# FAN DECKS

## 241MM DIAMETER • 181MM WIDTH

### HOUSING

G2 Galvabond®\* Steel Z275

### MOTOR

240 volts, 50 Hz  
 4 Pole  
 3 Speed  
 Ball Bearings  
 Class B Insulation  
 Automatic Thermal Overload Protection

### WHEEL

Steel

Unit Weight (kg)	20.0
Motor Part #	808555QVA-A11
Phase / Type	1ph CSR
Watts Output	750
Venting	Fully
Main Lead	1300
Connectors	B and E on earth
Capacitor Size	20 MFD
Capacitor Lead	1300
Connectors	F

B: Bootlace  
 E: Eyelet  
 F: Flag Terminals + Insulator on capacitor lead

### DIMENSIONS

	A	B	C	D	E	F	G	H	I	J	K	L	M
DXC241T181-521	813	308	165	175	234	239	762	257	325	-	160	185	327

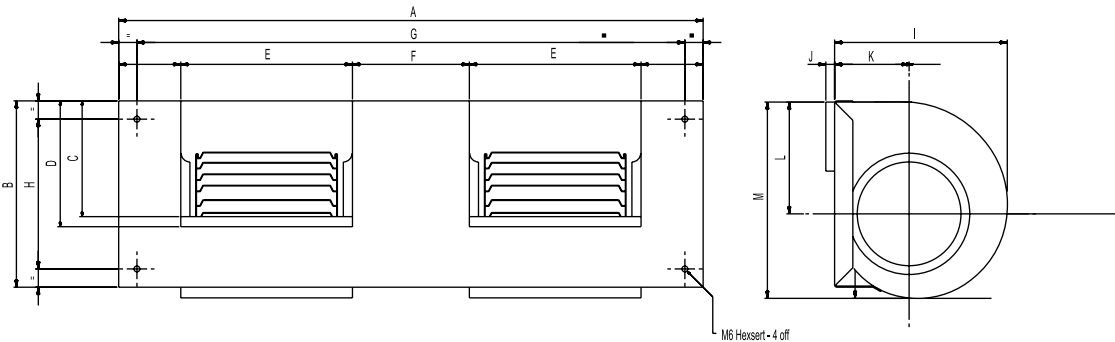

### PERFORMANCE GRAPH

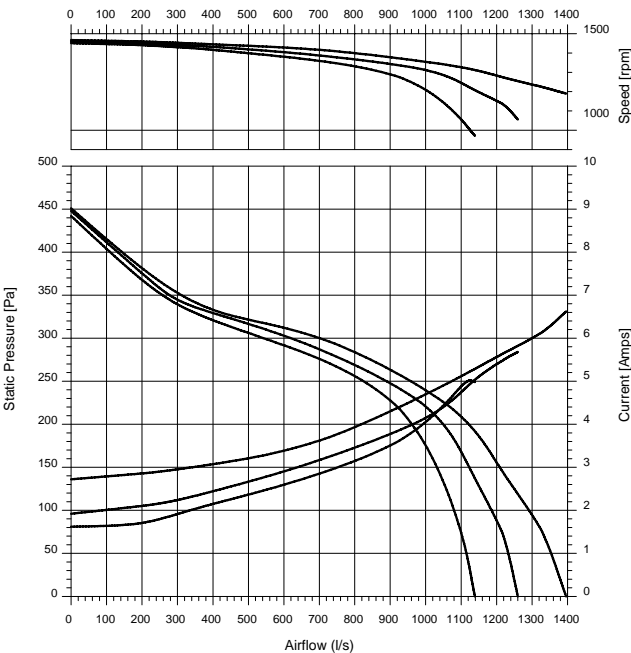

### WIRING DIAGRAM

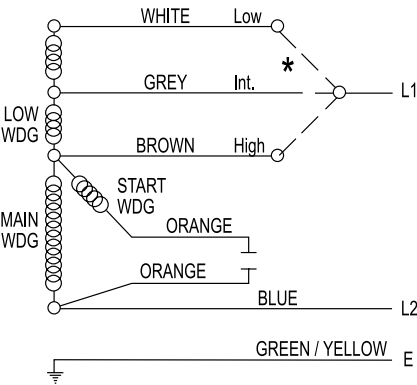

# FAN DECKS

## 241MM DIAMETER • 181MM WIDTH

### HOUSING

G2 Galvabond®\* Steel Z275

### MOTOR

240 volts, 50 Hz  
4 Pole  
3 Speed  
Ball Bearings  
Class B Insulation  
Automatic Thermal Overload Protection

### WHEEL

Polypropylene

Unit Weight (kg)	23.0
Motor Part #	808555QVA-A11
Phase / Type	1ph CSR
Watts Output	750
Venting	Fully
Main Lead	1300
Connectors	B and E on earth
Capacitor Size	15 MFD
Capacitor Lead	1300
Connectors	F

B: Bootlace  
E: Eyelet  
F: Flag Terminals + Insulator on capacitor lead

### DIMENSIONS

	A	B	C	D	E	F	G	H	I	J	K	L	M
DXG241-181-521	810	300	185	195	234	228	762	257	380	-	185	220	392

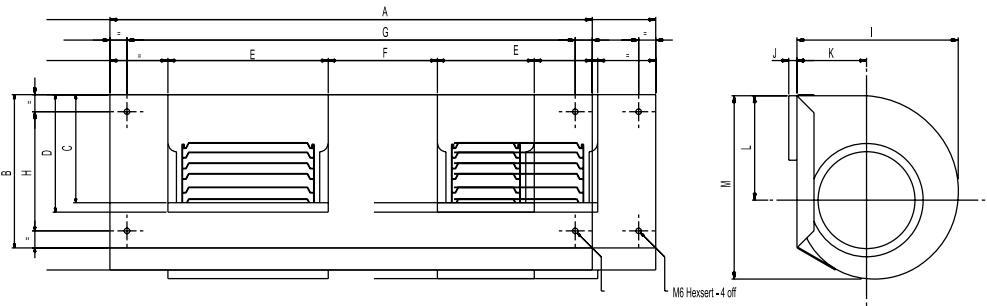

### PERFORMANCE GRAPH

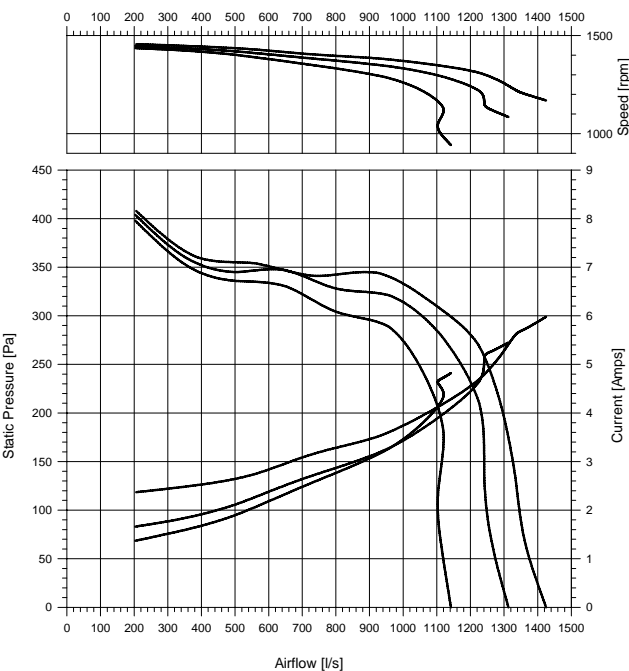

### WIRING DIAGRAM

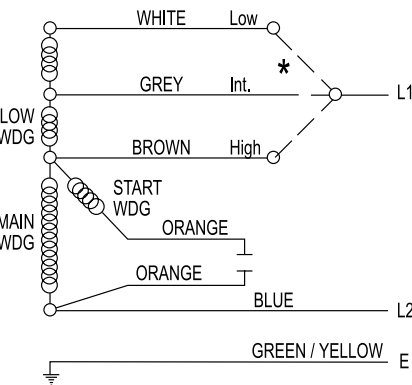

# FAN DECKS

## 241MM DIAMETER • 181MM WIDTH

### HOUSING

G2 Galvabond®\* Steel Z275

### MOTOR

240 volts, 50 Hz  
 4 Pole  
 3 Speed  
 Ball Bearings  
 Class B Insulation  
 Automatic Thermal Overload Protection

### WHEEL

Polypropylene

Unit Weight (kg)	20.0
Motor Part #	808555QVA-A11
Phase / Type	1ph CSR
Watts Output	750
Venting	Fully
Main Lead	1300
Connectors	B and E on earth
Capacitor Size	20 MFD
Capacitor Lead	1300
Connectors	F

B: Bootlace  
 E: Eyelet  
 F: Flag Terminals + Insulator on capacitor lead

### DIMENSIONS

	A	B	C	D	E	F	G	H	I	J	K	L	M
DXG241T181-521	813	308	165	175	234	239	762	257	325	-	160	185	327

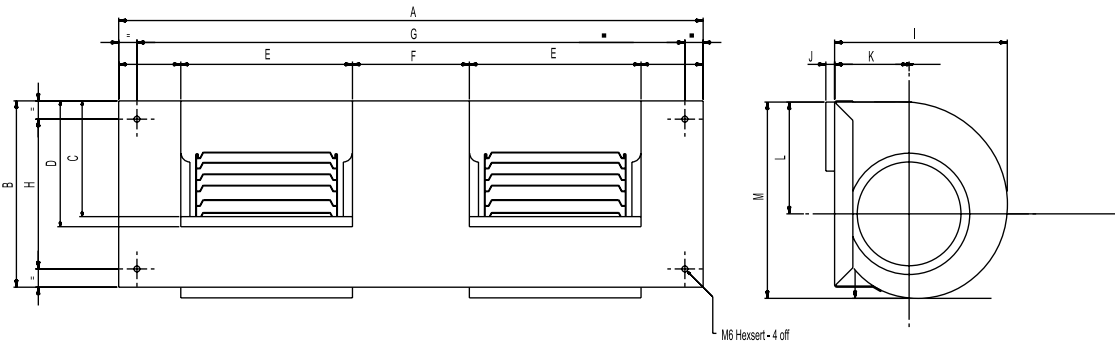

### PERFORMANCE GRAPH

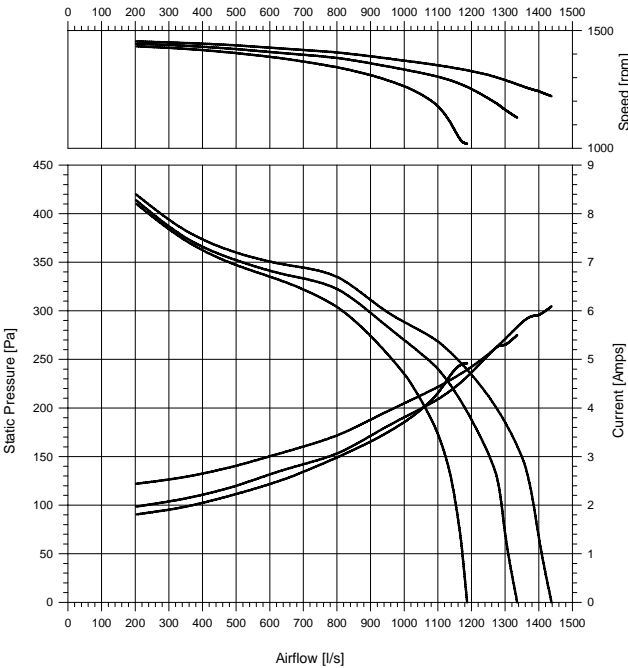

### WIRING DIAGRAM

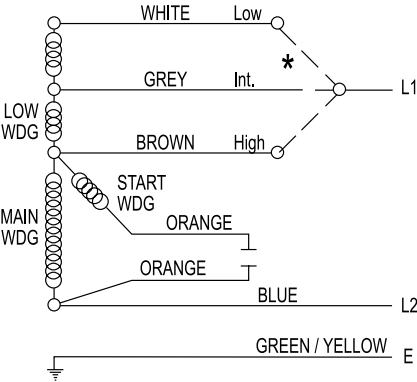



# FAN DECKS

## 241MM DIAMETER • 241MM WIDTH

### HOUSING

G2 Galvabond®\* Steel Z275

### MOTOR

240 volts, 50 Hz  
4 Pole  
3 Speed  
Ball Bearings  
Class B Insulation  
Automatic Thermal Overload Protection

### WHEEL

Polypropylene

Unit Weight (kg)	20.0
Motor Part #	808555PVA-A11
Phase / Type	1ph CSR
Watts Output	600
Venting	Fully
Main Lead	1000
Connectors	B and E on earth
Capacitor Size	15 MFD
Capacitor Lead	1000
Connectors	F

B: Bootlace  
E: Eyelet  
F: Flag Terminals + Insulator on capacitor lead

### DIMENSIONS

	A	B	C	D	E	F	G	H	I	J	K	L	M
DXG241T241-441	900	308	165	175	300	228	870	257	325	-	160	186	327

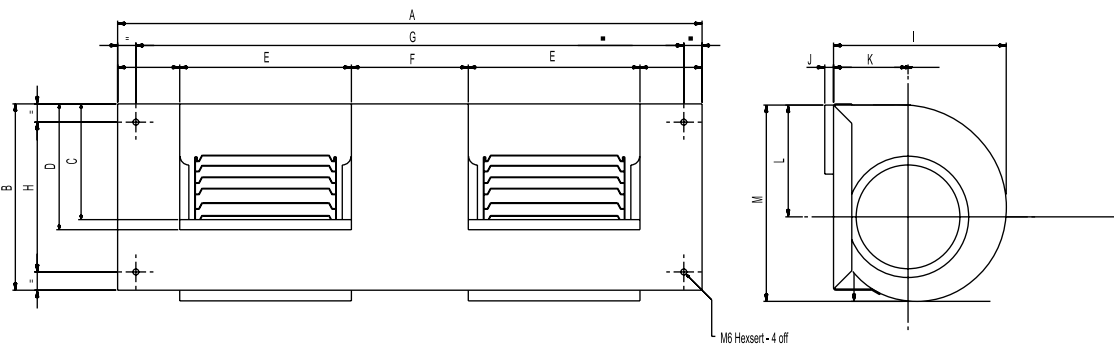

### PERFORMANCE GRAPH

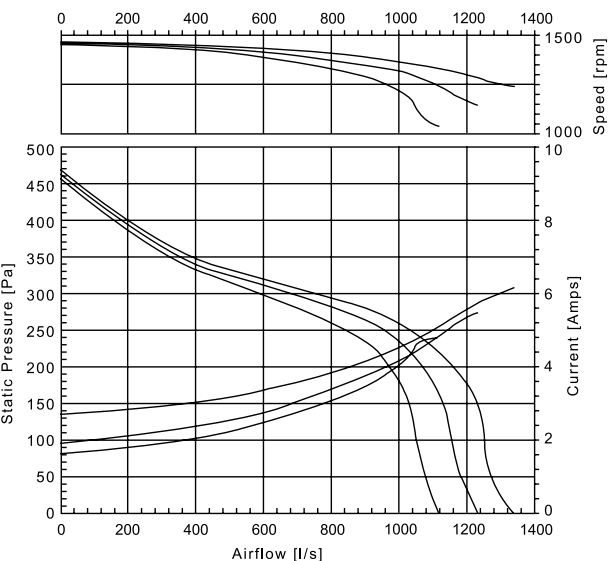

### WIRING DIAGRAM

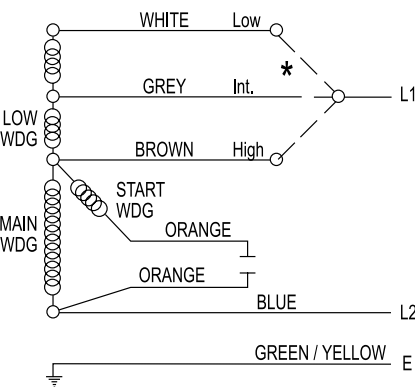

# FAN DECKS

## 241MM DIAMETER • 241MM WIDTH

### HOUSING

G2 Galvabond®\* Steel Z275

### MOTOR

240 volts, 50 Hz  
 4 Pole  
 3 Speed  
 Ball Bearings  
 Class B Insulation  
 Automatic Thermal Overload Protection

### WHEEL

Steel

Unit Weight (kg)	25.5
Motor Part #	808555QVA-A11
Phase / Type	1ph CSR
Watts Output	750
Venting	Fully
Main Lead	1300
Connectors	B and E on earth
Capacitor Size	20 MFD
Capacitor Lead	1300
Connectors	F

B: Bootlace  
 E: Eyelet  
 F: Flag Terminals + Insulator on capacitor lead

### DIMENSIONS

	A	B	C	D	E	F	G	H	I	J	K	L	M
DXC241-241-521	900	300	185	195	300	228	870	257	380	-	185	220	392

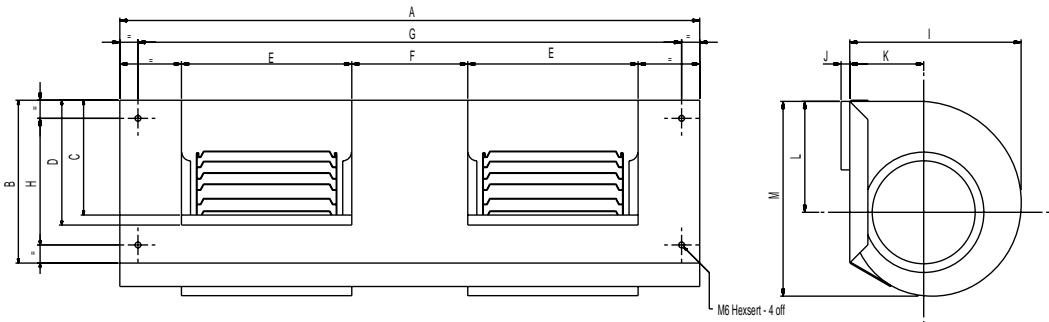

### PERFORMANCE GRAPH

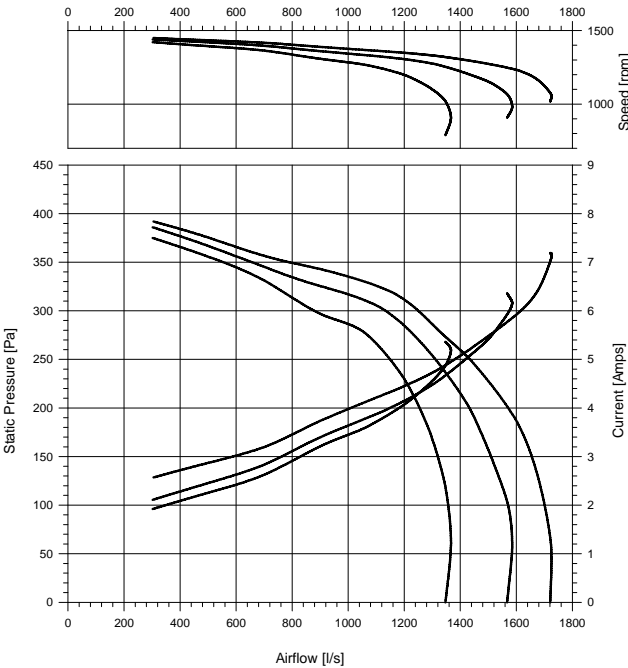

### WIRING DIAGRAM

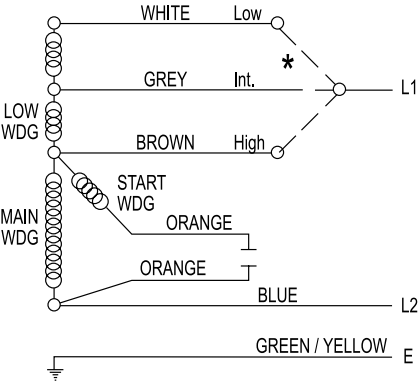

# FAN DECKS

## 241MM DIAMETER • 241MM WIDTH

### HOUSING

G2 Galvabond®\* Steel Z275

### MOTOR

240 volts, 50 Hz  
4 Pole  
3 Speed  
Ball Bearings  
Class B Insulation  
Automatic Thermal Overload Protection

### WHEEL

Polypropylene

Unit Weight (kg)	25.5
Motor Part #	808555QVA-A11
Phase / Type	1ph CSR
Watts Output	750
Venting	Fully
Main Lead	1300
Connectors	B and E on earth
Capacitor Size	20 MFD
Capacitor Lead	1300
Connectors	F

B: Bootlace  
E: Eyelet  
F: Flag Terminals + Insulator on capacitor lead

### DIMENSIONS

	A	B	C	D	E	F	G	H	I	J	K	L	M
DXG241-241-521	900	300	185	195	300	228	870	257	380	-	185	220	392

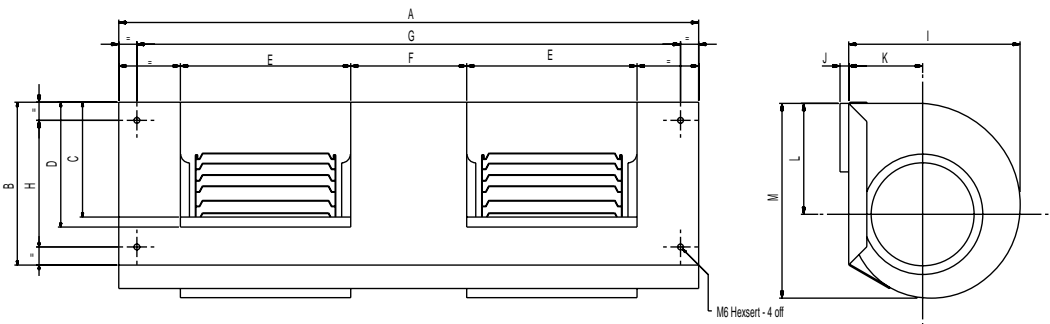

### PERFORMANCE GRAPH

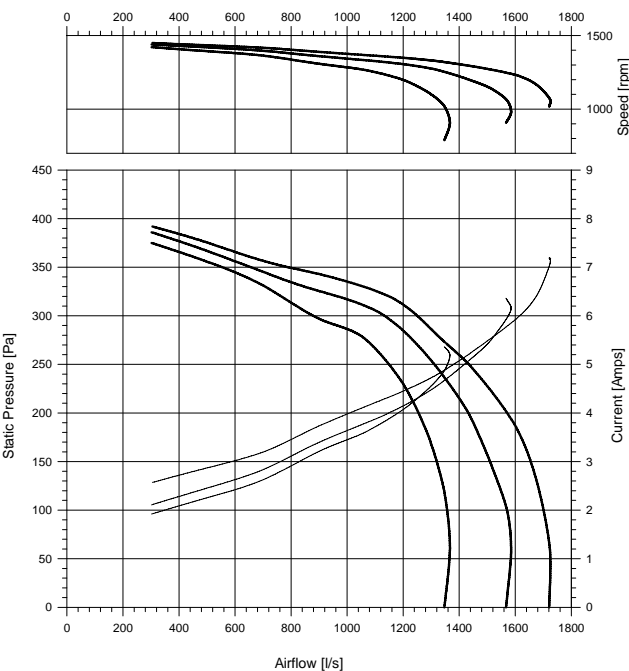

### WIRING DIAGRAM

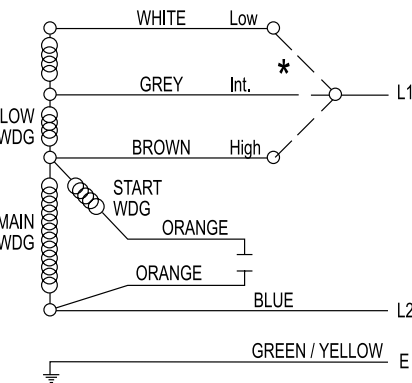

# FAN DECKS

## 241MM DIAMETER • 241MM WIDTH

### HOUSING

G2 Galvabond®\* Steel Z275

### MOTOR

240 volts, 50 Hz  
 4 Pole  
 3 Speed  
 Ball Bearings  
 Class B Insulation  
 Automatic Thermal Overload Protection

### WHEEL

Steel

Unit Weight (kg)	25.5
Motor Part #	808555QVA-A23
Phase / Type	1ph CSR
Watts Output	760
Venting	Fully
Main Lead	1000
Connectors	F and E on earth
Capacitor Size	20 MFD
Capacitor Lead	1000
Connectors	F

B: Bootlace  
 E: Eyelet  
 F: Flag Terminals + Insulator on capacitor lead

### DIMENSIONS

	A	B	C	D	E	F	G	H	I	J	K	L	M
DXC241-241-523	900	300	185	195	300	228	870	257	380	-	185	220	392

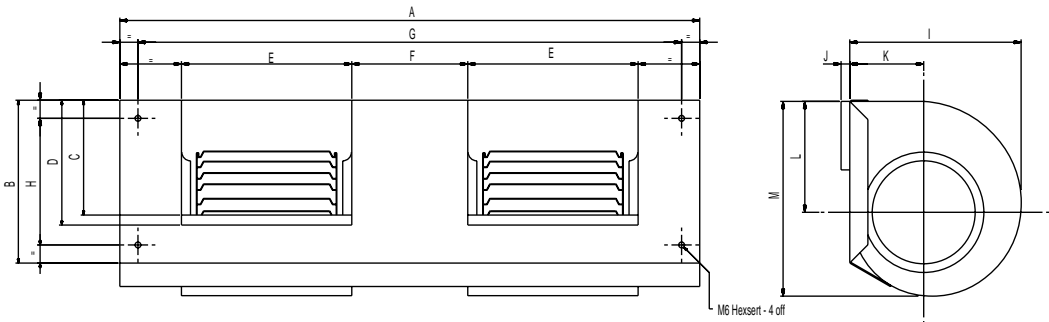

### PERFORMANCE GRAPH

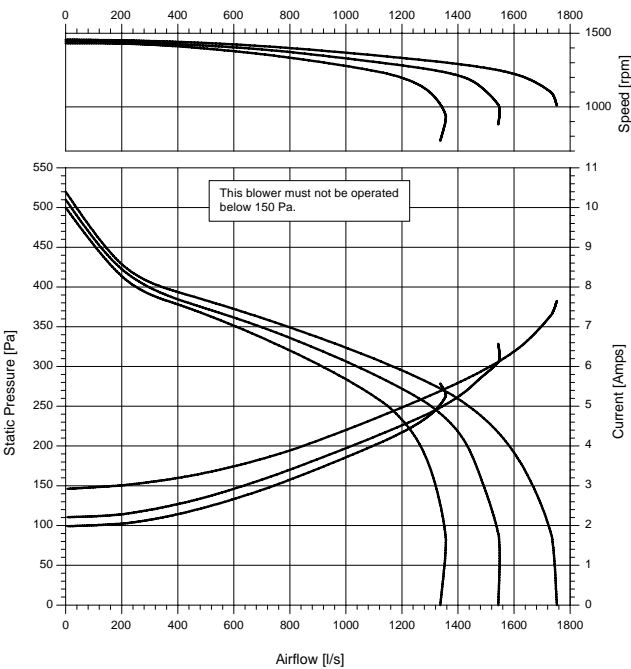

### WIRING DIAGRAM

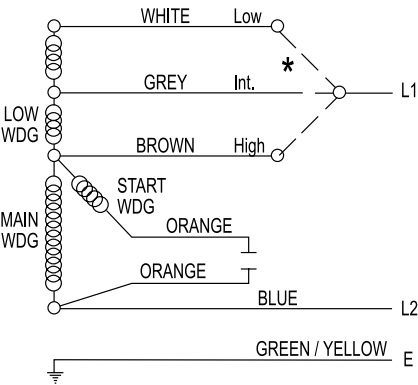

# FAN DECKS

## 241MM DIAMETER • 241MM WIDTH

### HOUSING

G2 Galvabond®\* Steel Z275

### MOTOR

240 volts, 50 Hz  
4 Pole  
3 Speed  
Ball Bearings  
Class B Insulation  
Automatic Thermal Overload Protection

### WHEEL

Steel

Unit Weight (kg)	23.0
Motor Part #	809455SVA-B12
Phase / Type	1ph CSR
Watts Output	1100
Venting	Fully
Main Lead	1500
Connectors	B and E on earth
Capacitor Size	30 MFD
Capacitor Lead	1500
Connectors	F

B: Bootlace  
E: Eyelet  
F: Flag Terminals + Insulator on capacitor lead

### DIMENSIONS

	A	B	C	D	E	F	G	H	I	J	K	L	M
DXC241-241-541	1040	304	185	195	300	338	990	250	380	-	185	220	392

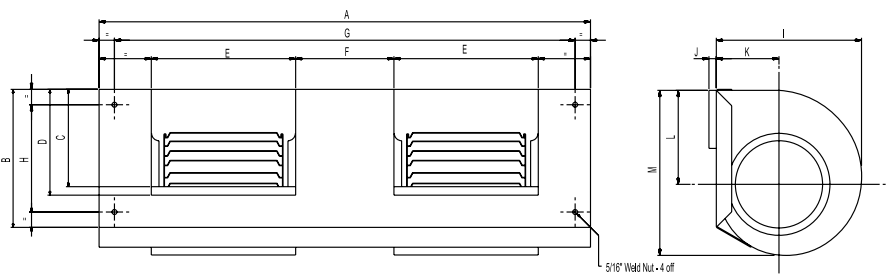

### PERFORMANCE GRAPH

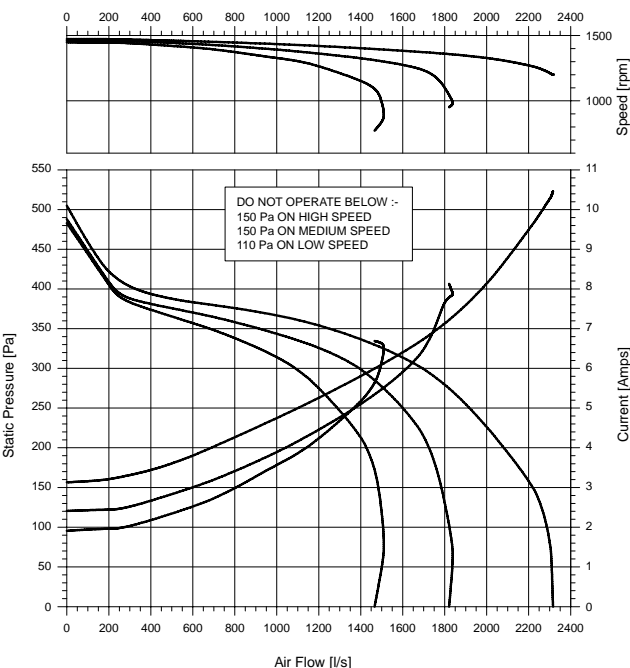

### WIRING DIAGRAM

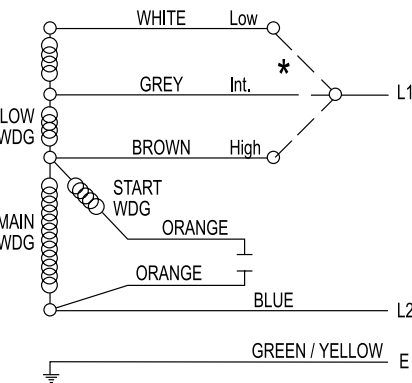

# FAN DECKS

## 241MM DIAMETER • 241MM WIDTH

### HOUSING

G2 Galvabond®\* Steel Z275

### MOTOR

240 volts, 50 Hz  
 4 Pole  
 3 Speed  
 Ball Bearings  
 Class B Insulation  
 Automatic Thermal Overload Protection

### WHEEL

Polypropylene

Unit Weight (kg)	23.0
Motor Part #	809455SVA-B12
Phase / Type	1ph CSR
Watts Output	1100
Venting	Fully
Main Lead	1500
Connectors	B and E on earth
Capacitor Size	30 MFD
Capacitor Lead	1500
Connectors	F

B: Bootlace  
 E: Eyelet  
 F: Flag Terminals + Insulator on capacitor lead

### DIMENSIONS

	A	B	C	D	E	F	G	H	I	J	K	L	M
DXG241-241-541	1040	304	185	195	300	338	990	250	380	-	185	220	392

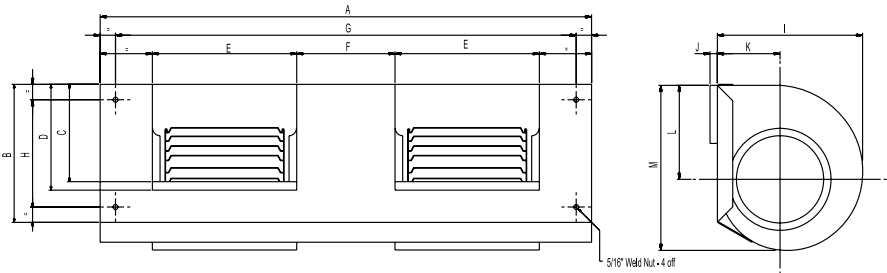

### PERFORMANCE GRAPH

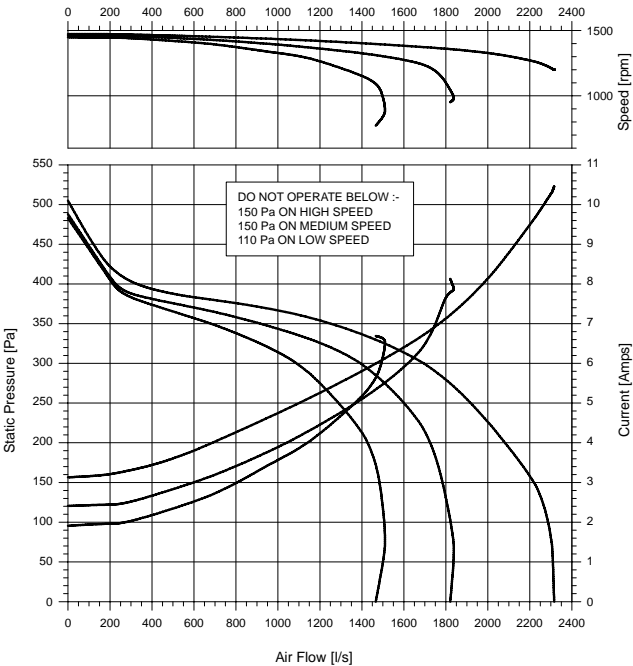

### WIRING DIAGRAM

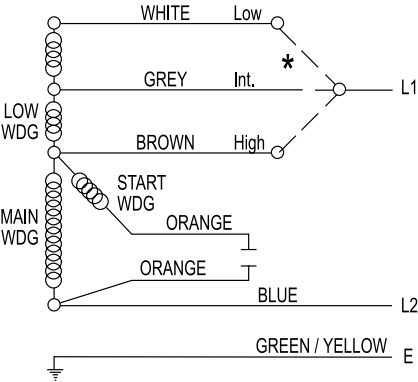



**Regal Beloit Australia Pty Ltd** ABN 61 122 303 084

19 Corporate Ave (PO Box 2340)

Rowville VIC 3178, AUSTRALIA

Customer Service: 1300 888 853

Fax: +61 3 9237 4050

[www.regalaustralia.com.au](http://www.regalaustralia.com.au)

#### **VICTORIA / HEAD OFFICE**

19 Corporate Avenue

Rowville VIC 3178

T: 1300 888 853

F: +61 3 9237 4050

#### **NEW SOUTH WALES**

8 Bushells Place

Wetherill Park NSW 2164

T: 1300 888 853

F: +61 2 8781 3131

#### **QUEENSLAND**

7 Mahogany Court

Willawong QLD 4110

T: 1300 888 853

F: +61 7 3246 3210

CAIRNS (Service • Repairs • Sales)

2/159-161 Newell Street

Bungalow QLD 4870

T: 1300 888 853

F: +61 7 4033 5553

#### **MACKAY**

Shed 5/58 Elvin Street

Paget QLD 4740

T: 1300 888 853

F: +61 7 4952 6277

#### **SOUTH AUSTRALIA**

47 Research Road

Pooraka SA 5095

T: 1300 888 853

F: +61 8 8359 5675

#### **WESTERN AUSTRALIA**

21 Colin Jamieson Drive

Welshpool WA 6106

T: 1300 888 853

F: +61 8 6253 3710

#### **NEW ZEALAND**

Regal Beloit New Zealand Ltd

#### **AUCKLAND**

18 Jomac Place

Avondale

T: 0800 676 722

F: +64 9 820 8504

#### **ROTORUA**

91 Tallyho Street

Rotorua

T: 0800 676 722

F: +64 7 347 8629

#### **MALAYSIA**

Torin Industries SND BHD (MALAYSIA)

No. 6536A Jalan Bukit Kemuning

Batu 6 Seksyen 34

40470 Shah Alam Selangor

T: +60 3 5124 6157

F: +60 3 5121 1467

#### **SINGAPORE**

Regal Beloit South East Asia Pte. Ltd.

12 Tuas Loop 637346

SINGAPORE

T: +65 6863 3473

F: +65 6863 3476

#### **THAILAND**

FASCO Motors (Thailand) Limited

29/7-8 Bangkruay-Sainoi Road

Bangkrang

Muang Nonthaburi District Nonthaburi 11000

THAILAND

T: +66 2447 3300

F: +66 2447 3500

#### **APPLICATION CONSIDERATIONS**

The proper selection and application of air system products and components, including the related area of product safety, is the responsibility of the customer. Operating and performance requirements and potential associated issues will vary appreciably depending upon the use and application of such products and components. The scope of the technical and application information included in this publication is necessarily limited. Unusual operating environments and conditions, lubrication requirements, loading supports, and other factors can materially affect the application and operating results of the products and components and the customer should carefully review its requirements. Any technical advice or review furnished by Regal Beloit Australia Pty Ltd and its affiliates with respect to the use of products and components is given in good faith and without charge, and Regal assumes no obligation or liability for the advice given, or results obtained, all such advice and review being given and accepted at customer's risk.

For a copy of our Standard Terms and Conditions of Sale, Disclaimers of Warranty and Limitation of Liability, please contact Customer Service at 1300 888 853 or visit [www.regalaustralia.com.au](http://www.regalaustralia.com.au). These terms and conditions of sale, disclaimers and limitations of liability apply to any person who may buy, acquire or use a Regal Beloit Australia Pty Ltd product referred to herein, including any person who buys from a licensed distributor of these branded products.

Regal and Genteq are trademarks of Regal Beloit Australia Pty Ltd or one of its affiliated companies.

\*Galvabond is believed to be the trademark or tradename of Bluescope Steel Limited and is not controlled by Regal Beloit Corporation.  
©2017, 2017 Regal Beloit Australia Pty Ltd, All Rights Reserved. MCC16068E • G0004 • r8 • Created in AU

**REGAL**®